

TERMINAL CONNECTORS

CABLE LUG

A303 Cable lug DTL

DTL series of copper-aluminum wiring terminals are suitable for transition of the circular aluminum wires, hemicycle-sector aluminum wire, power supply cable in the distribution equipment and copper terminals of the electrical equipment. The material of aluminum and copper made of L3 and T2.

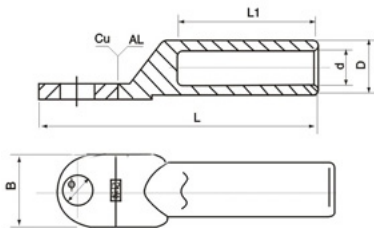

ITEM NO	Dimension(mm)					
	G	d	L	L1	B	
DTL1-10	8.5	10	6	68	28.0	16.0
DTL1-16	8.5	11	6	70	30.0	16.0
DTL1-25	8.5	12	7	75	34.0	18.0
DTL1-35	10.5	14	8.5	85	38.0	20.5
DTL1-50	10.5	16	9.8	90	40.0	23.0
DTL1-70	12.5	18	11.5	102	48.0	26.0
DTL1-95	12.5	21	13.5	112	50.0	28.0
DTL1-120	14.5	23	15	120	53.0	30.0
DTL1-150	14.5	25	16.5	126	56.0	34.0
DTL1-185	16.5	27	18.5	133	58.0	37.0
DTL1-240	16.5	30	21	140	60.0	40.0
DTL1-300	21.0	34	23.5	160	65.0	50.0

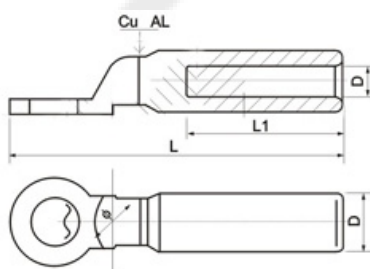

ITEM NO	Dimension(mm)				
	G	d	L	L1	
DTL2-10	13	16	5.5	87	42.0
DTL2-16	13	16	6.5	87	42.0
DTL2-25	13	16	8	87	42.0
DTL2-35	13	16	9	87	42.0
DTL2-50	13	20	11	87	43.0
DTL2-70	13	20	12.5	87	43.0
DTL2-95	13	20	13.5	87	43.0
DTL2-120	13	25	15.5	111	60.0
DTL2-150	13	25	17.5	111	60.0
DTL2-185	13	32	19.5	116	60.0
DTL2-240	13	32	22.5	116	60.0
DTL2-300	13	34	23.5	120	62.0